

**ATTENTION:**  
 This layout displays exhibition areas only. All other areas, like e.g. registration, cloakroom, f&b will decrease your exhibition spaces!

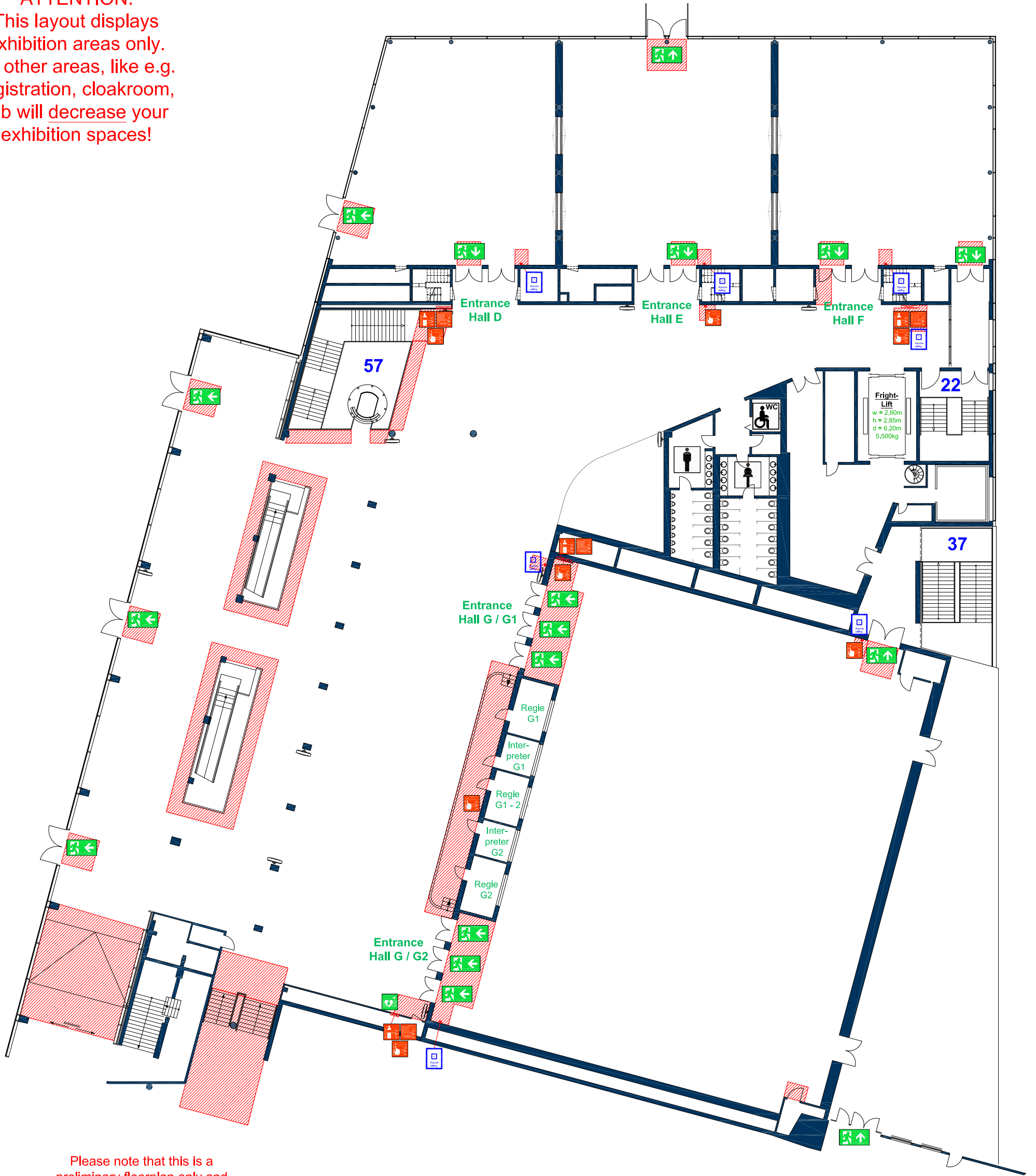

Please note that this is a preliminary floorplan only and can be subject to modifications!  
 All dimensions are approximate and should be verified on the spot.

Second Floor	Event: Date:
Hall D	Floor space = 266,00 sqm
Hall E	Floor space = 283,00 sqm
Hall F	Floor space = 289,00 sqm
Hall G	Floor space = 1.058,00 sqm
Foyer D-G	Floor space = 1.668,00 sqm

**Hall D - F height**

Ceiling height 4,50 m  
 Max. construction height 4,00 m

**Hall G height**

Ceiling height 6,50 m  
 Max. construction height 5,50 m

**Foyer D-G height**

Ceiling height 4,50m / 6,80 m  
 height under suspension 4,20 m  
 Max. construction height 3,50m / 4,00 m

**Floor Hall G**

Flooring: Parquet / Natural Stone  
 Area loading 500 kg/sqm



Emergency exit



Fire extinguisher, fire alarms  
 fire hose, fire hydrant

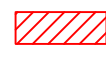

Protected area



Escape area