

Foyer 3 + H Factsheet

Foyer 3 + H serves as the entrance area for Hall 3 while also providing direct access to Hall H. Its unique architecture features numerous pillars which create an intimate atmosphere. This is further enhanced by the foyer's remote-controlled LED indirect lighting system enabling a wide range of illumination scenarios.

Ideal for welcome receptions, coffee breaks or smaller exhibitions in connection with other events.

Building section	Center
Floor	Ground floor
Gross area (m ²)	1,487
Clear height (m)	3.85 4.10
Divisible	No
Daylight	No
Exhibitions	Yes

Key Facts

- **Ceiling height:**
3.85 m / 4.10 m
- **Flooring:**
Parquet
- **Cloakroom:**
Permanent cloakroom with 800 hooks (conditional)

Other services

- **Exhibition use:**
 - Exhibition area*:
max. 468 m² net
 - Floor load:
500 kg/m²
- **Audio**:**
 - Ceiling-mounted loudspeakers for announcements and voice transmission
- **Video**:**
 - Digital signage system with individually-addressable monitors
- **Lighting**:**
 - 3-phase busbar system for light fixtures

Floorplan

Floorplan Foyer 3 + H:

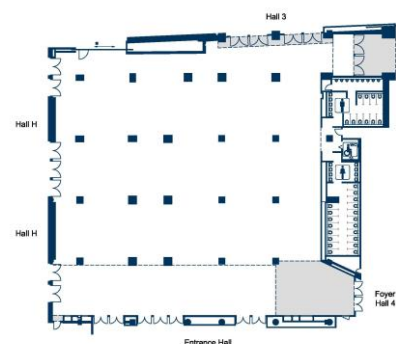

All information is subject to change.

- * Depending on specific usage.
- ** Use of audio, video and other technical equipment not included in hall rental fee. We will gladly put together an individual proposal.