

Important information for people with mobility impairments

CCH - Congress Center Hamburg is designed for accessibility

All the conference halls and foyers, and the roof garden, are equipped with ramps or lifts to ensure easy access for people with mobility impairments. The lifts are generously dimensioned, the same applies to the disabled toilets throughout the CCH.

The CCH is located right next to Hamburg-Dammtor station, which is served directly by high-speed ICE trains and the rapid transit S-Bahn system. It is only a few metres from there to the CCH. We recommend use of Entrance A, Tiergartenstrasse 2, which gives step-free access.

On arrival at Hamburg-Dammtor station, use the exit to "CCH / Dag-Hammarskjöld-Platz" and keep right. Then take the path between the Radisson Blu Hotel and the railway line, passing the Radisson Blu Hotel on the right (but do not go through the pedestrian tunnel). The path has a slight upward gradient. After about 100 metres you get to a turning circle, with Entrance A of the CCH located on the left.

This entrance is the best one to choose if you need a car or taxi to drop you at the CCH and are dependent on help. The reception at Entrance A always has staff on duty, and the CCH staff will take you directly to the conference halls you want.

If you arrive in your own car, you can park in the CCH underground car park (entrance via Marseiller Strasse). All the disabled parking spaces are clearly marked. They are located near the lifts, which take you directly to the entrance level of the CCH.

The CCH service staff is there for you round the clock. You can request their help anywhere in the building, on service hotline +49 40 3569 – 2671 or via the in-house telephones on - 2671.

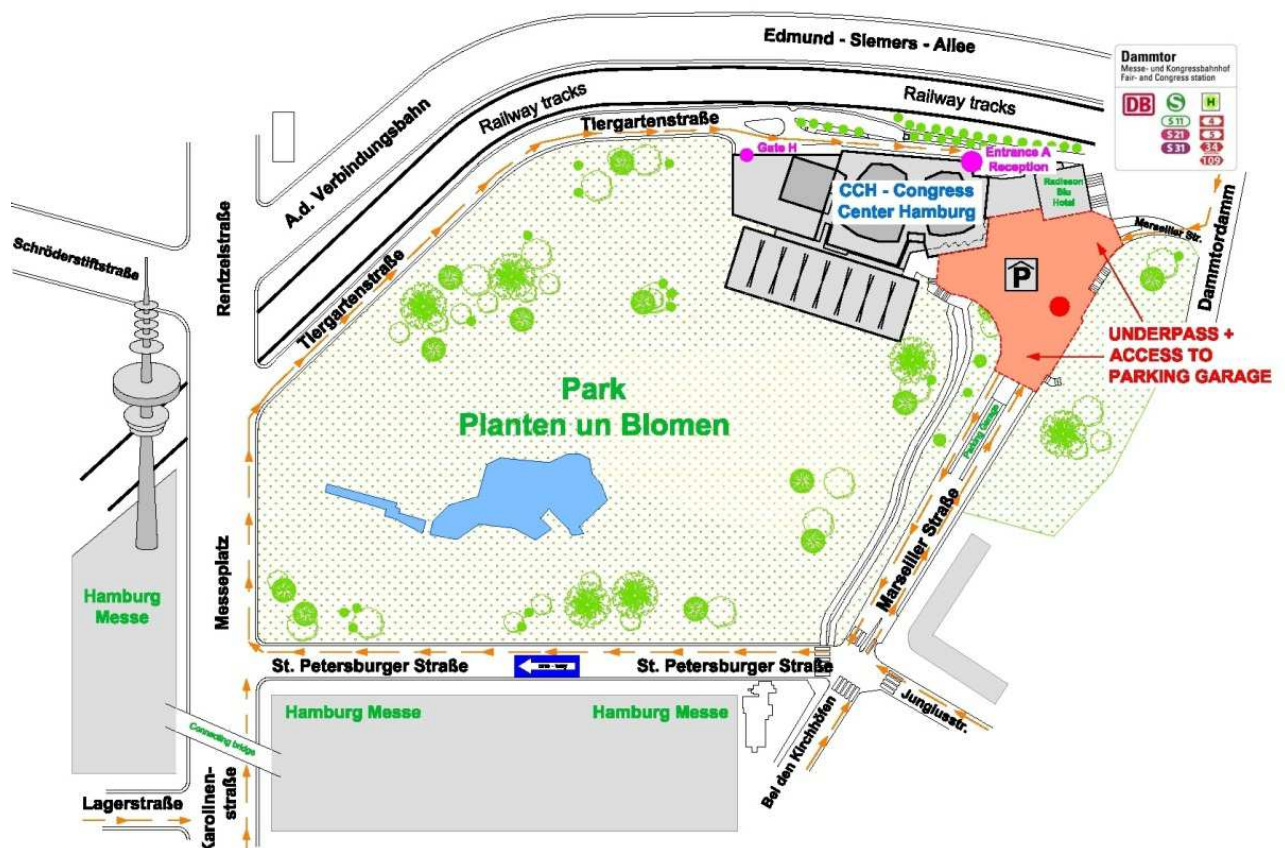

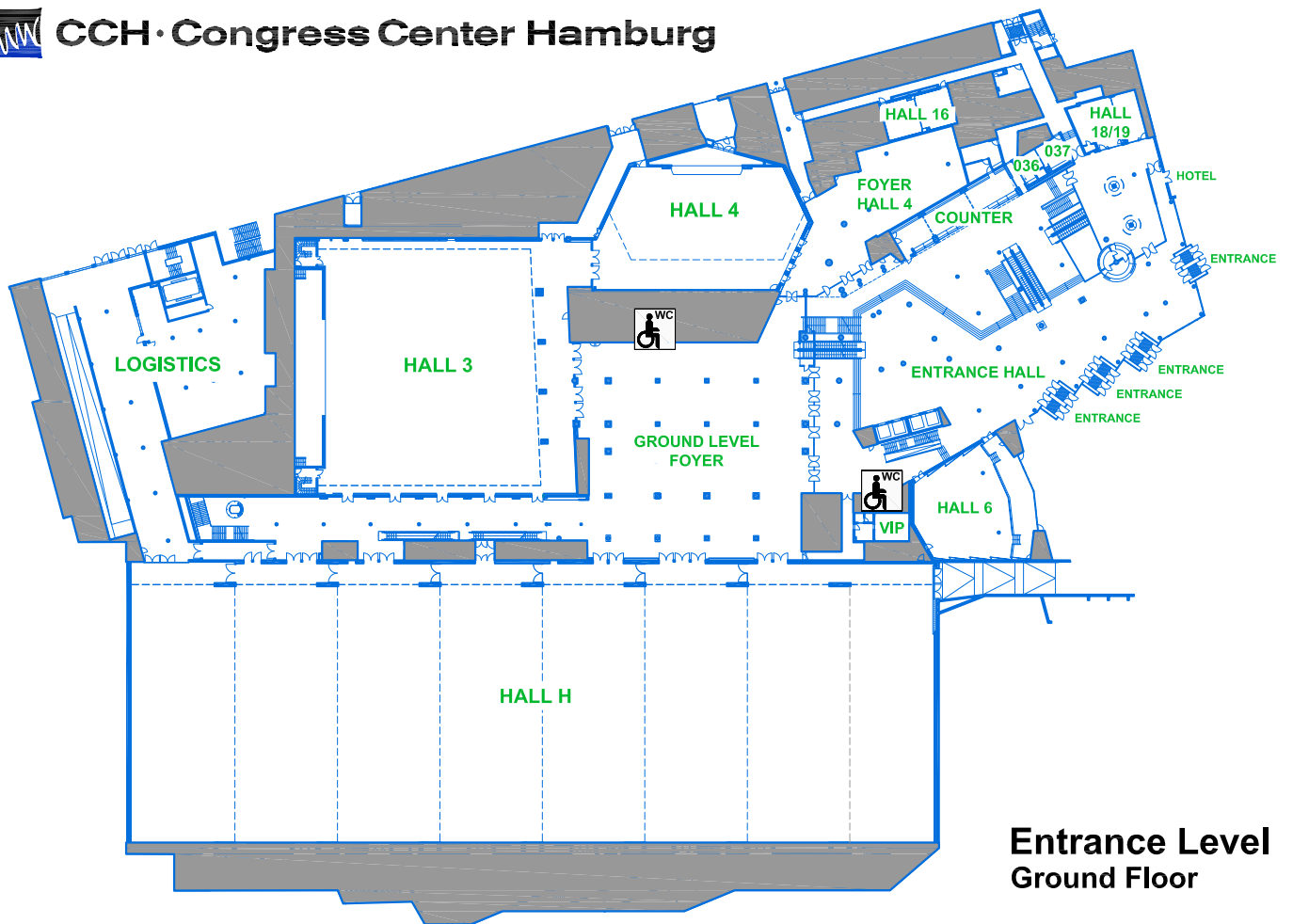

**Entrance Level
Ground Floor**

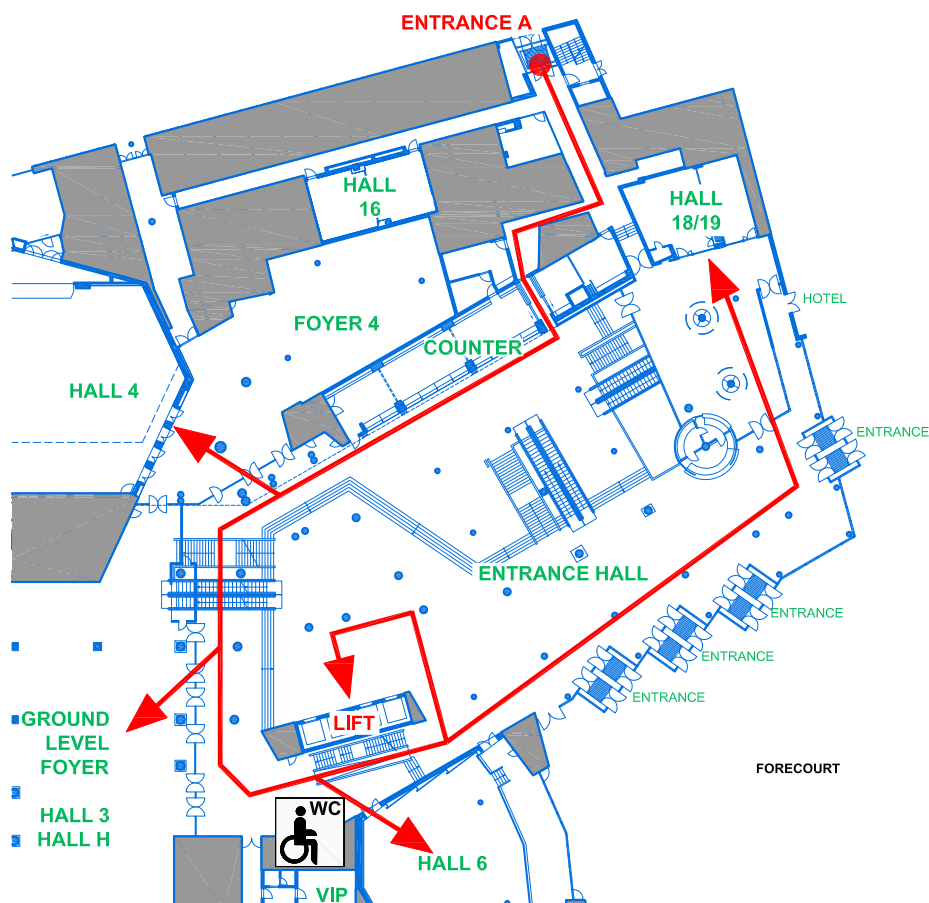

**Entrance Hall
Ground Floor**

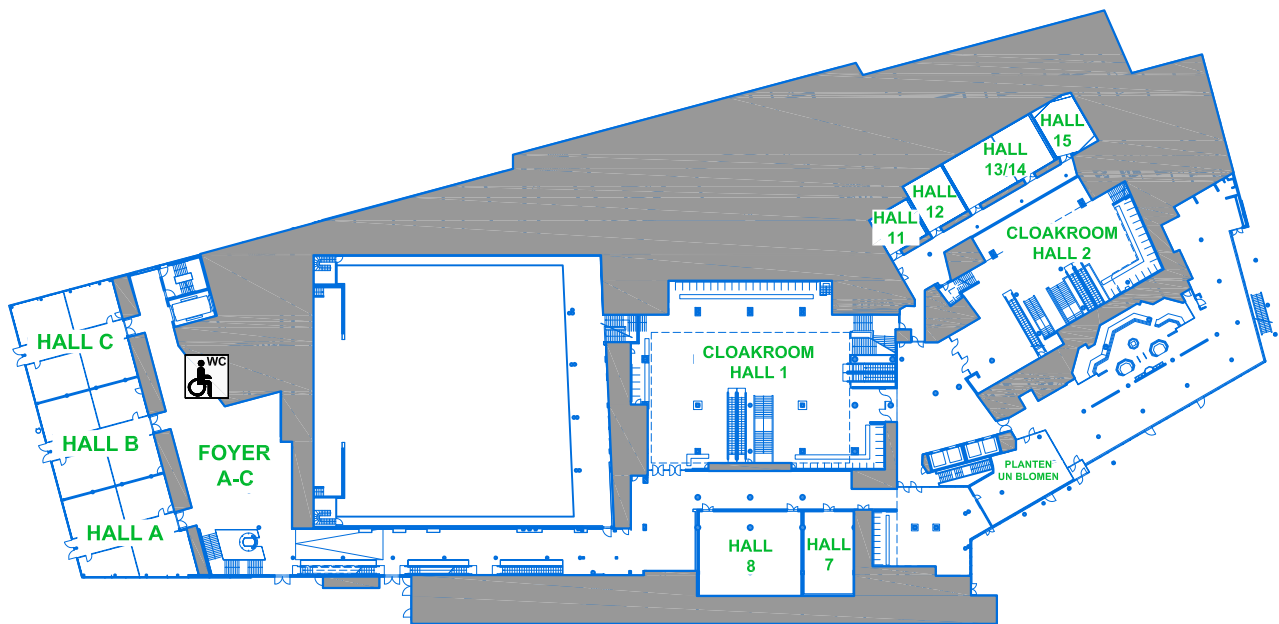

First Floor

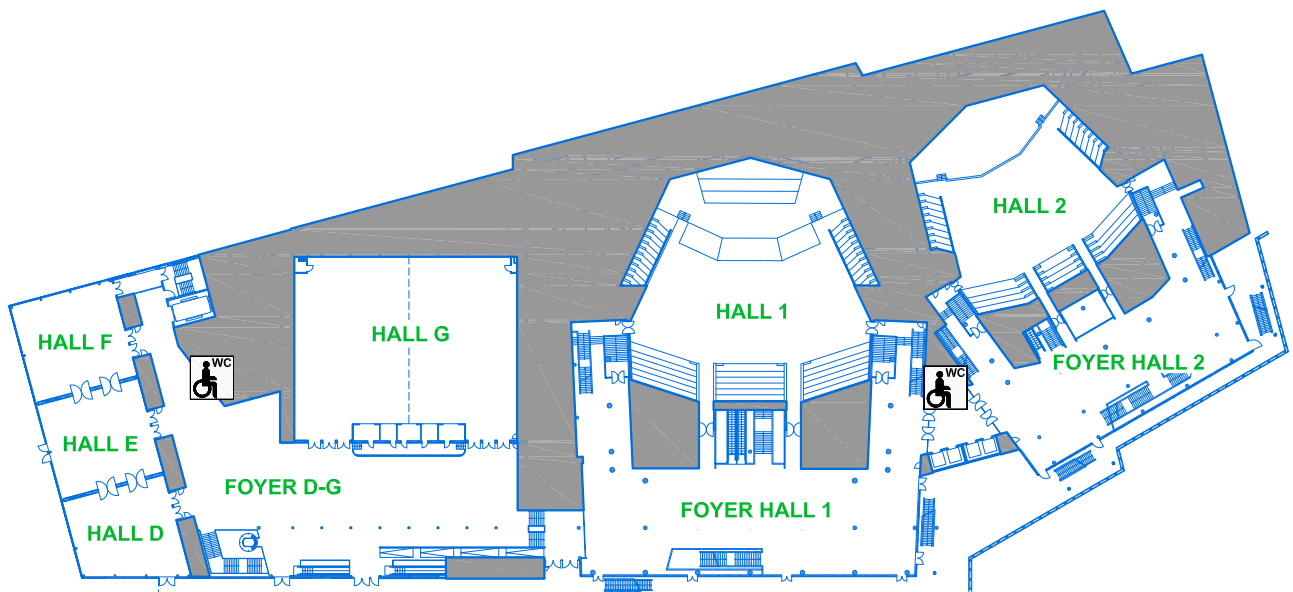

Second Floor